

APPROVED L.C.C. NO. = 4563/SIDA. DATE = 08.10.2020  
 APPROVED SITE PLAN NO. = 0109161217900699. DATE = 23.01.2021

PROJECT :- PROPOSED GROUND PARKING + 4 (FOUR) STORED RESIDENTIAL BUILDING AT DON BOSCO COLONY, WARD NO.- 42 (S.M.C.), SILGURI, P.S.- BHAKTINAGAR, DIST.- JALPAIGURI

OWNER :- ANCHAL ENCLAVE PVT. LTD., REPRESENTED BY SRI ABHISHEK GOLAN, S/O- SRI GOPAL GOLAN.

LAND SCHEDULE :-

MOZA : DARBANGA  
 PRAANA : BAKHTHAPUR  
 J.L. NO. : 02  
 SHEET NO. : 04 (R.S.), 04 (L.R.)  
 KHATAN NO. : 840/11 (R.S.), 2143 (L.R.)  
 PLOT NO. : 18 (R.S.), 380 (L.R.)  
 WARD NO. : 42 (S.M.C.)  
 HOLDING NO. : 41/100/C/83  
 DISTRICT : BHAKTINAGAR  
 P.T. : JALPAIGURI

AREA STATEMENT

LAND AREA AS PER DEED	: 714,882 m <sup>2</sup>
LAND AREA AS SITE	: 703,093 m <sup>2</sup>
PERMISSIBLE GROUND COVERAGE	: 50.00 % OR 351,944 m <sup>2</sup>
PROPOSED GROUND COVERAGE	: 49.914 % OR 350,944 m <sup>2</sup>
AREA OF GROUND FLOOR	: 350,944 m <sup>2</sup>
AREA OF 1st, 2nd, 3rd & 4th FL. (EACH)	: 350,944 m <sup>2</sup>
TOTAL FLOOR AREA	: 1754,720 m <sup>2</sup>
FLOOR AREA RATIO - PERM. = 225. PROP. = 1743	
AREA OF STAIR CASE & LIFT	: 44,575 m <sup>2</sup>
LEFT OPEN SPACE	: 352,149 m <sup>2</sup>
PERMISSIBLE HT. OF THE BUILDING	: 40.00 m.
PROPOSED HT. OF THE BUILDING	: 14.995 m.
PARKING REQUIRED PROVIDED	: 306,369 m <sup>2</sup>
NUMBER OF TENEMENTS	: 20 NOS.
AREA OF TENAMENT	: 0
USE OF THE BUILDING	: GROUND PARKING + 4 STD. RESIDENTIAL BUILDING

DECLARATION OF OWNER

I DO HEREBY DECLARE THAT THE BUILDING PROPOSED FOR CONSTRUCTION SHALL BE IN COMPLETE ACCORDANCE WITH THE APPLICABLE ACTS AND REGULATIONS IN FORCE AND THAT I AM NOT APPLYING FOR CONSTRUCTION OF ANY OTHER BUILDING OR STRUCTURE ON THE SITE.

SIGNATURE OF OWNER: *[Signature]*  
 Director, Anchal Enclave Pvt. Ltd.

DECLARATION OF L.B.S.

FOR CONSTRUCTION OF THE BUILDING AND SECTION AND OTHER STRUCTURAL DETAILS AND FOR THE POSITION AND SPACING OF THE BUILDING PROPOSED FOR CONSTRUCTION ON PLOT NO. 18 (R.S.), 380 (L.R.) STREET S.M.C. ROAD WARD NO. 42 UNDER THE JURISDICTION OF SILGURI MUNICIPAL CORPORATION, NOTIFIED AREA INDUSTRIAL TOWNSHIP, INDUSTRIAL ZONE, SILGURI, WEST MIDNAPUR DISTRICT, WEST BENGAL STATE.

SIGN. OF STRUC. ENGINEER: *[Signature]*  
 Suresh Chatterjee  
 G. Tech. Engineer, Class-1  
 S.M.C. Emp. No. 0987  
 457, Bidan Road, Siliguri  
 Ph. No. 97330-0515  
 E-mail: s\_chatterjee01@gmail.com

SIGN. OF GEO-TECHNICAL ENGINEER: *[Signature]*  
 Somnath Bhadra  
 G. Tech. Engineer, Class-1  
 S.M.C. Emp. No. 0987  
 457, Bidan Road, Siliguri  
 Ph. No. 97330-0515  
 E-mail: s\_bhadra01@gmail.com

DRAWN BY: IRNE ALI  
 SHEET NO. - 1/2  
 SIGN. OF L.B.S. (SCALE: 1:100)

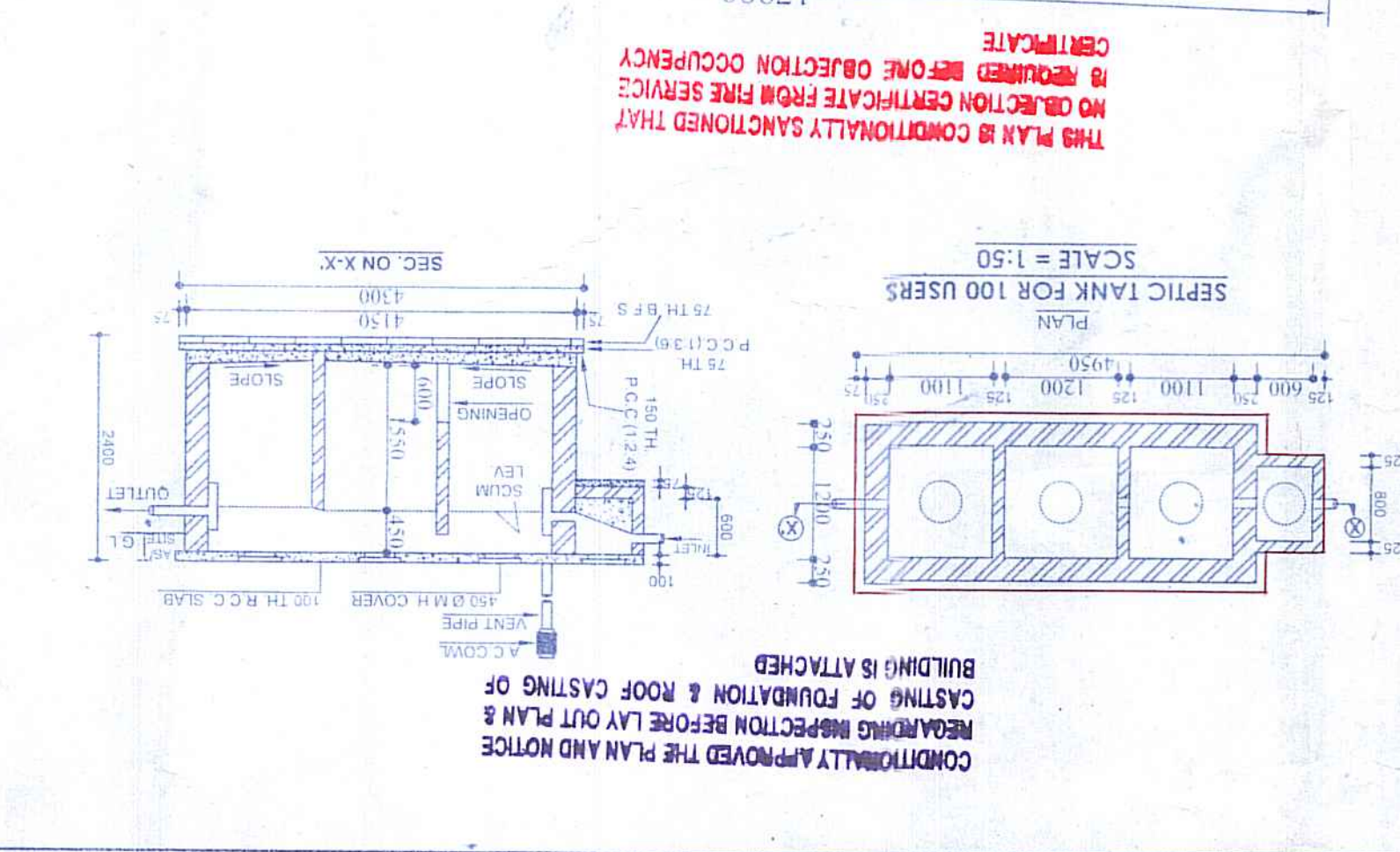
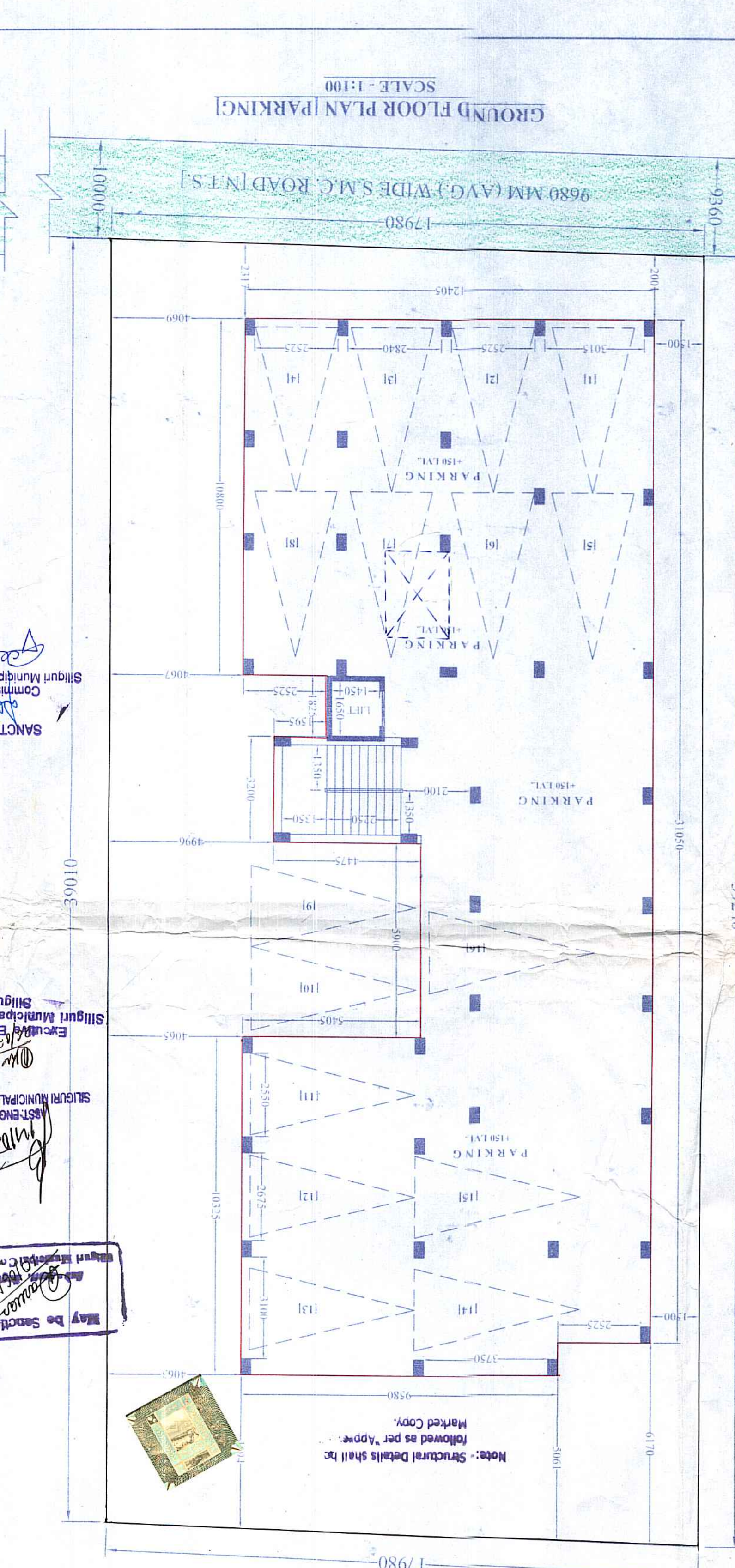
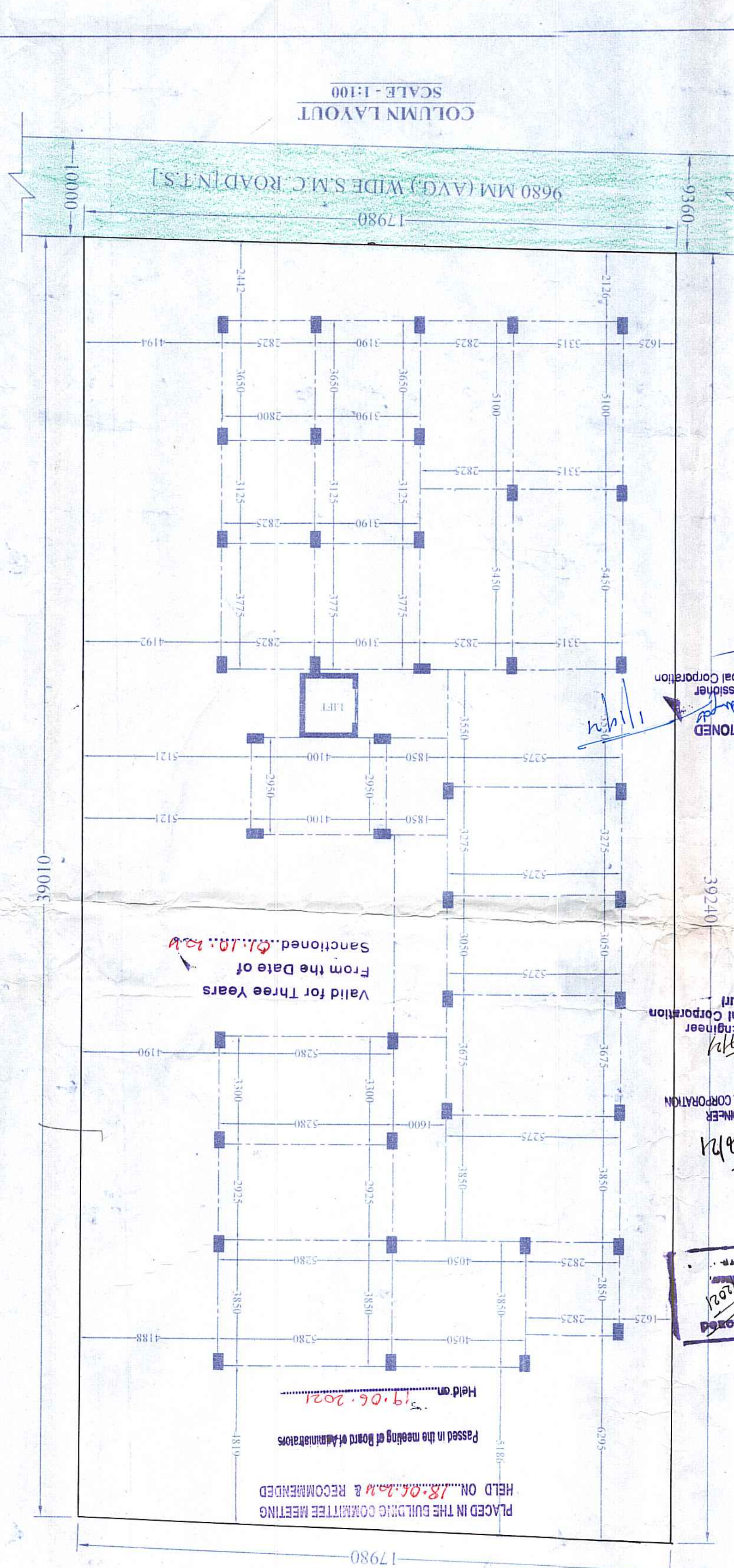
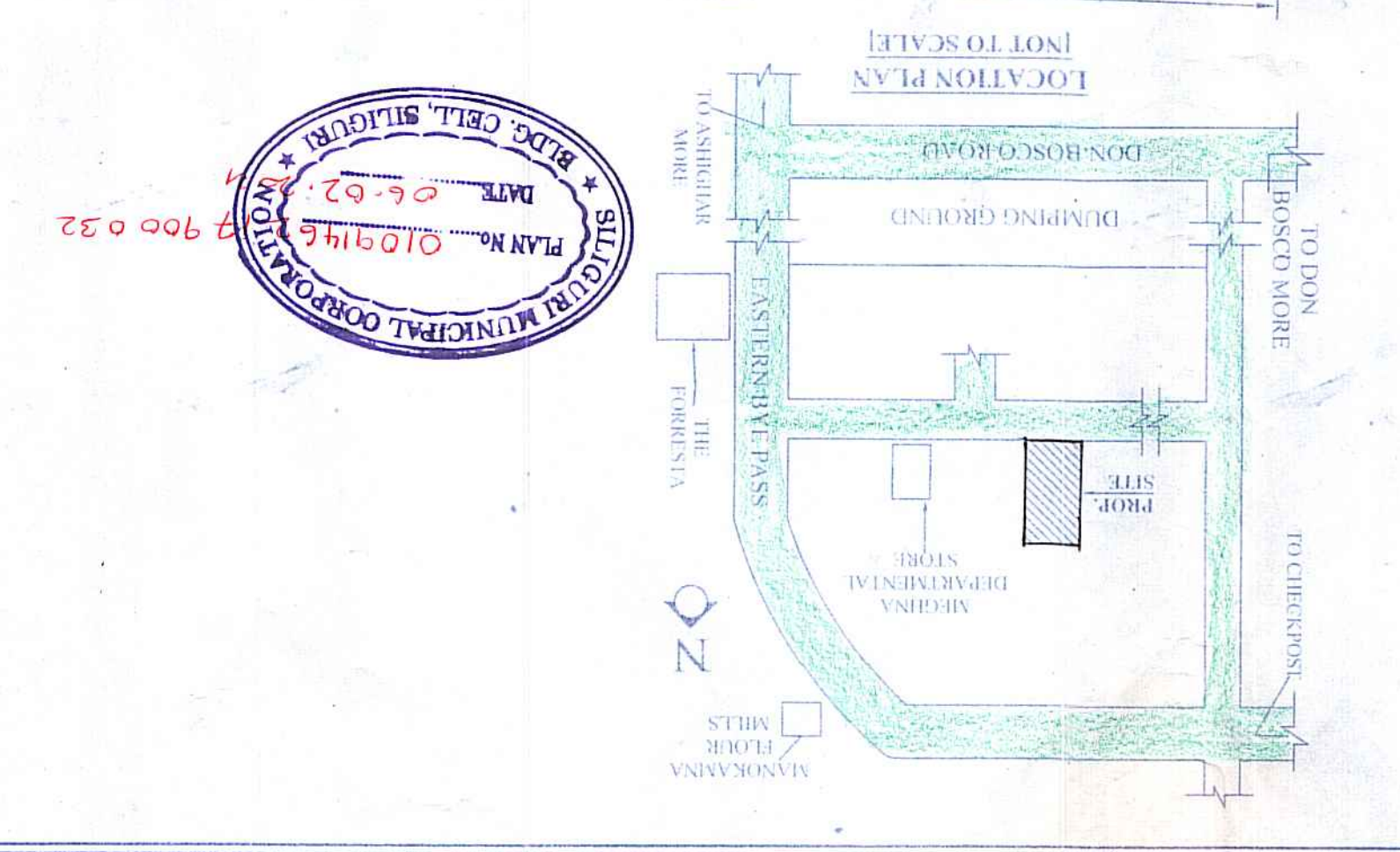

DECLARATION OF L.B.S.

FOR CONSTRUCTION OF THE BUILDING AND SECTION AND OTHER STRUCTURAL DETAILS AND FOR THE POSITION AND SPACING OF THE BUILDING PROPOSED FOR CONSTRUCTION ON PLOT NO. 18 (R.S.), 380 (L.R.) STREET S.M.C. ROAD WARD NO. 42 UNDER THE JURISDICTION OF SILGURI MUNICIPAL CORPORATION, NOTIFIED AREA INDUSTRIAL TOWNSHIP, INDUSTRIAL ZONE, SILGURI, WEST MIDNAPUR DISTRICT, WEST BENGAL STATE.

SIGNATURE OF OWNER: *[Signature]*  
 Director, Anchal Enclave Pvt. Ltd.

SIGNATURE OF STRUC. ENGINEER: *[Signature]*  
 Suresh Chatterjee

SIGNATURE OF GEO-TECHNICAL ENGINEER: *[Signature]*  
 Somnath Bhadra

LAND AREA AS PER DEED: 714,882 m<sup>2</sup>  
 LAND AREA AS SITE: 703,093 m<sup>2</sup>  
 PERMISSIBLE GROUND COVERAGE: 50.00 % OR 351,944 m<sup>2</sup>  
 PROPOSED GROUND COVERAGE: 49.914 % OR 350,944 m<sup>2</sup>  
 AREA OF GROUND FLOOR: 350,944 m<sup>2</sup>  
 AREA OF 1st, 2nd, 3rd & 4th FL. (EACH): 350,944 m<sup>2</sup>  
 TOTAL FLOOR AREA: 1754,720 m<sup>2</sup>  
 FLOOR AREA RATIO - PERM. = 225. PROP. = 1743  
 AREA OF STAIR CASE & LIFT: 44,575 m<sup>2</sup>  
 LEFT OPEN SPACE: 352,149 m<sup>2</sup>  
 PERMISSIBLE HT. OF THE BUILDING: 40.00 m.  
 PROPOSED HT. OF THE BUILDING: 14.995 m.  
 PARKING REQUIRED PROVIDED: 306,369 m<sup>2</sup>  
 NUMBER OF TENEMENTS: 20 NOS.  
 AREA OF TENAMENT: 0  
 USE OF THE BUILDING: GROUND PARKING + 4 STD. RESIDENTIAL BUILDING

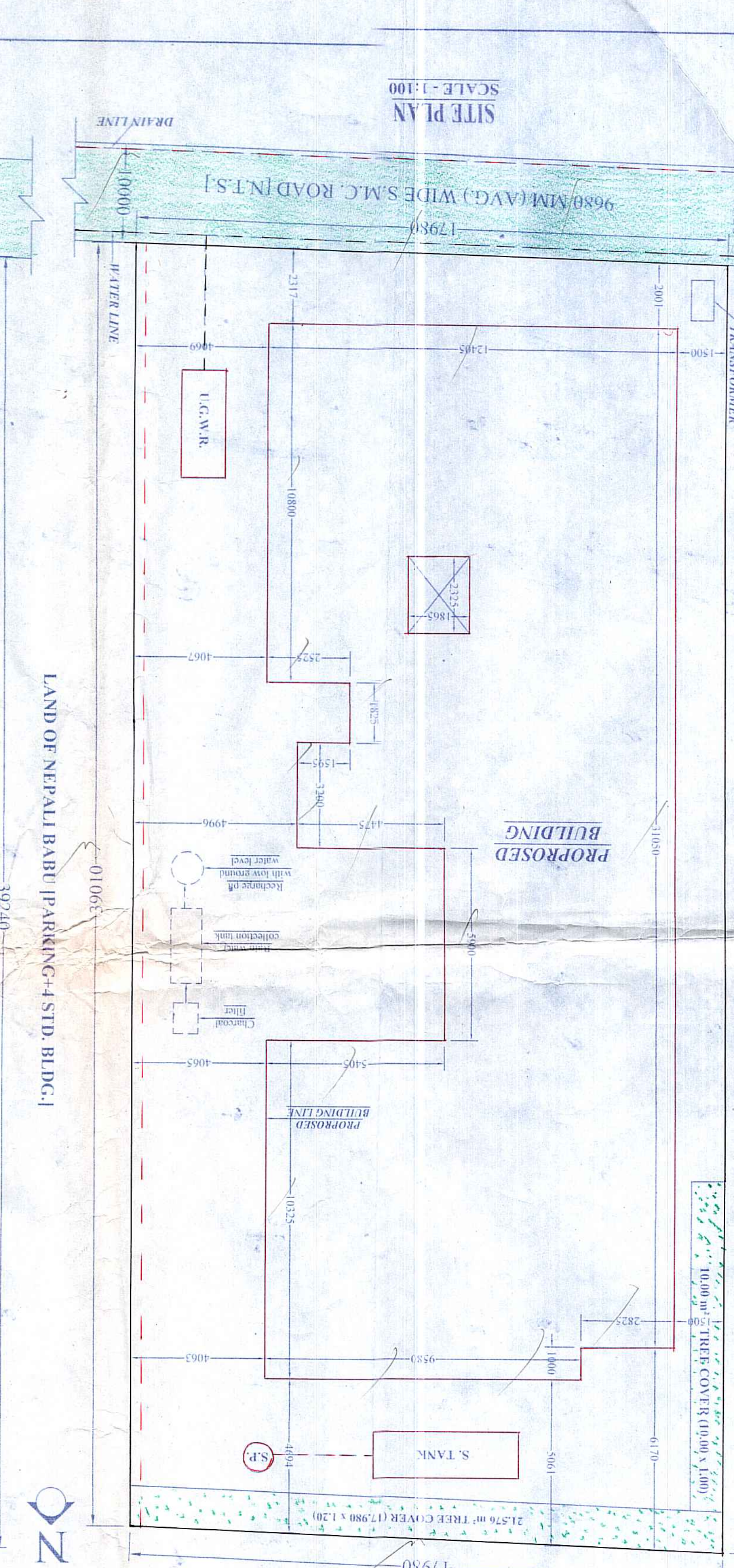
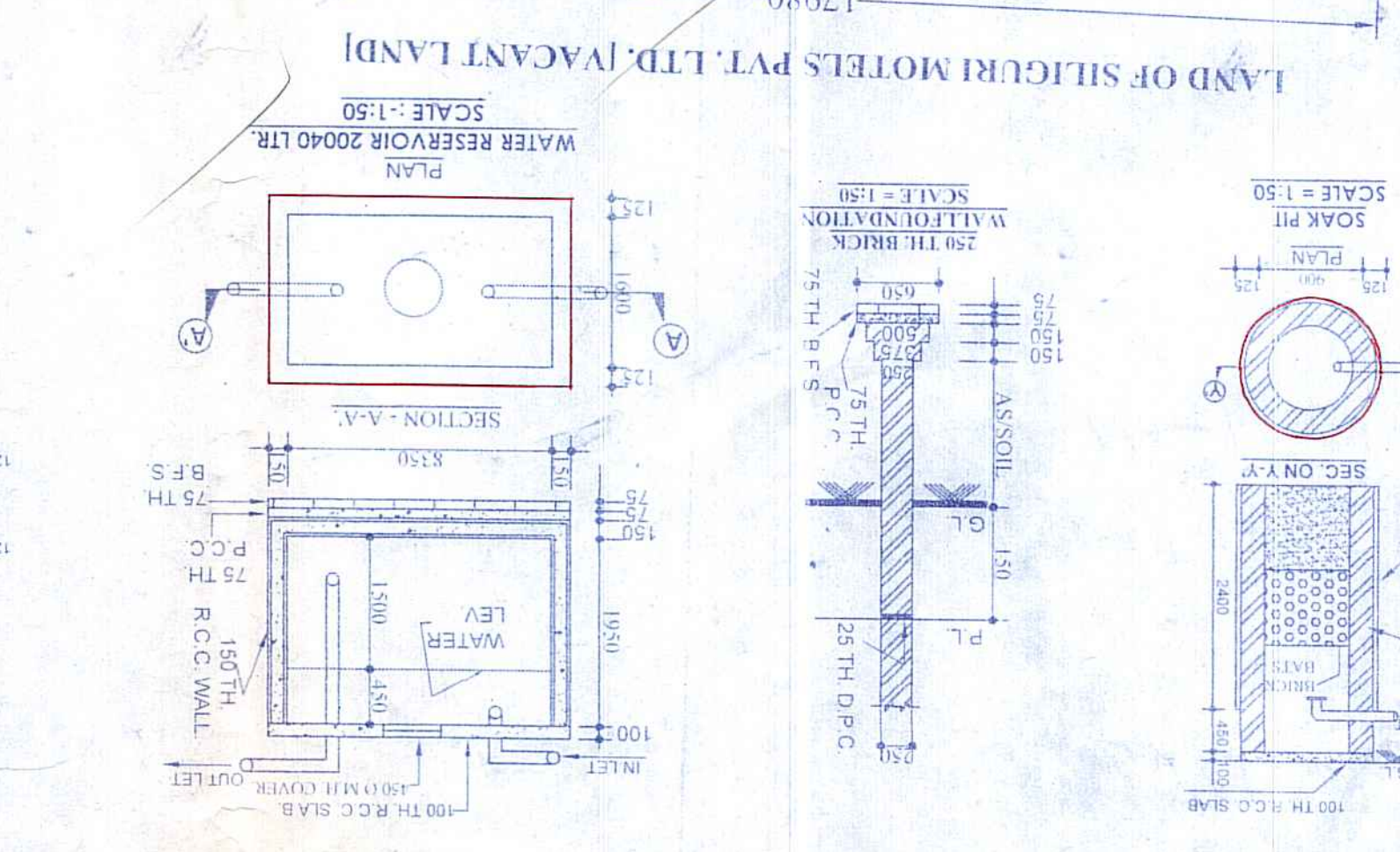

DECLARATION OF OWNER

I DO HEREBY DECLARE THAT THE BUILDING PROPOSED FOR CONSTRUCTION SHALL BE IN COMPLETE ACCORDANCE WITH THE APPLICABLE ACTS AND REGULATIONS IN FORCE AND THAT I AM NOT APPLYING FOR CONSTRUCTION OF ANY OTHER BUILDING OR STRUCTURE ON THE SITE.

SIGNATURE OF OWNER: *[Signature]*  
 Director, Anchal Enclave Pvt. Ltd.

SIGNATURE OF STRUC. ENGINEER: *[Signature]*  
 Suresh Chatterjee

SIGNATURE OF GEO-TECHNICAL ENGINEER: *[Signature]*  
 Somnath Bhadra

LAND AREA AS PER DEED: 714,882 m<sup>2</sup>  
 LAND AREA AS SITE: 703,093 m<sup>2</sup>  
 PERMISSIBLE GROUND COVERAGE: 50.00 % OR 351,944 m<sup>2</sup>  
 PROPOSED GROUND COVERAGE: 49.914 % OR 350,944 m<sup>2</sup>  
 AREA OF GROUND FLOOR: 350,944 m<sup>2</sup>  
 AREA OF 1st, 2nd, 3rd & 4th FL. (EACH): 350,944 m<sup>2</sup>  
 TOTAL FLOOR AREA: 1754,720 m<sup>2</sup>  
 FLOOR AREA RATIO - PERM. = 225. PROP. = 1743  
 AREA OF STAIR CASE & LIFT: 44,575 m<sup>2</sup>  
 LEFT OPEN SPACE: 352,149 m<sup>2</sup>  
 PERMISSIBLE HT. OF THE BUILDING: 40.00 m.  
 PROPOSED HT. OF THE BUILDING: 14.995 m.  
 PARKING REQUIRED PROVIDED: 306,369 m<sup>2</sup>  
 NUMBER OF TENEMENTS: 20 NOS.  
 AREA OF TENAMENT: 0  
 USE OF THE BUILDING: GROUND PARKING + 4 STD. RESIDENTIAL BUILDING

LAND OF NEPALI BABU (PARKING+4 STD. BLDG.)  
 LAND OF MRS SHELL JAIN (VACANT LAND)  
 LAND OF SILGURI MOTELS PVT. LTD. (VACANT LAND)

CONDITIONALLY APPROVED THE PLAN AND NOTICE REGARDING INSPECTION BEFORE LAY OUT PLAN & CASTING OF FOUNDATION & ROOF CASTING OF BUILDING IS ATTACHED

NO OBJECTION CERTIFICATE FROM FIRE SERVICE IS REQUIRED BEFORE OBTAINING OCCUPANCY CERTIFICATE

THIS PLAN IS CONDITIONALLY SANCTIONED THAT

STRUCTURAL DETAILS SHALL BE FOLLOWED AS PER APPROVED COPY.

PLACED IN THE BUILDING COMMITTEE MEETING HELD ON 18.06.2021 & RECOMMENDED

Passed in the meeting of Board of Managers

Valid for Three Years From the Date of Sanctioning

Sanctioned by: *[Signature]*

Commissioner, Siliguri Municipal Corporation

Sanctioned by: *[Signature]*  
 Assistant Engineer, Siliguri Municipal Corporation

Sanctioned by: *[Signature]*  
 Assistant Engineer, Siliguri Municipal Corporation

APPROVED L.C.C. NO. = 4563/SIDA. DATE = 08.10.2020  
 APPROVED SITE PLAN NO. = 0109161217900699. DATE = 23.01.2021

PROJECT :- PROPOSED GROUND PARKING + 4 (FOUR) STORED RESIDENTIAL BUILDING AT DON BOSCO COLONY, WARD NO.- 42 (S.M.C.), SILGURI, P.S.- BHAKTINAGAR, DIST.- JALPAIGURI

OWNER :- ANCHAL ENCLAVE PVT. LTD., REPRESENTED BY SRI ABHISHEK GOLAN, S/O- SRI GOPAL GOLAN.

LAND SCHEDULE :-

MOZA : DARBANGA  
 PRAANA : BAKHTHAPUR  
 J.L. NO. : 02  
 SHEET NO. : 04 (R.S.), 04 (L.R.)  
 KHATAN NO. : 840/11 (R.S.), 2143 (L.R.)  
 PLOT NO. : 18 (R.S.), 380 (L.R.)  
 WARD NO. : 42 (S.M.C.)  
 HOLDING NO. : 41/100/C/83  
 DISTRICT : BHAKTINAGAR  
 P.T. : JALPAIGURI

AREA STATEMENT

LAND AREA AS PER DEED	: 714,882 m <sup>2</sup>
LAND AREA AS SITE	: 703,093 m <sup>2</sup>
PERMISSIBLE GROUND COVERAGE	: 50.00 % OR 351,944 m <sup>2</sup>
PROPOSED GROUND COVERAGE	: 49.914 % OR 350,944 m <sup>2</sup>
AREA OF GROUND FLOOR	: 350,944 m <sup>2</sup>
AREA OF 1st, 2nd, 3rd & 4th FL. (EACH)	: 350,944 m <sup>2</sup>
TOTAL FLOOR AREA	: 1754,720 m <sup>2</sup>
FLOOR AREA RATIO - PERM. = 225. PROP. = 1743	
AREA OF STAIR CASE & LIFT	: 44,575 m <sup>2</sup>
LEFT OPEN SPACE	: 352,149 m <sup>2</sup>
PERMISSIBLE HT. OF THE BUILDING	: 40.00 m.
PROPOSED HT. OF THE BUILDING	: 14.995 m.
PARKING REQUIRED PROVIDED	: 306,369 m <sup>2</sup>
NUMBER OF TENEMENTS	: 20 NOS.
AREA OF TENAMENT	: 0
USE OF THE BUILDING	: GROUND PARKING + 4 STD. RESIDENTIAL BUILDING

DECLARATION OF OWNER

I DO HEREBY DECLARE THAT THE BUILDING PROPOSED FOR CONSTRUCTION SHALL BE IN COMPLETE ACCORDANCE WITH THE APPLICABLE ACTS AND REGULATIONS IN FORCE AND THAT I AM NOT APPLYING FOR CONSTRUCTION OF ANY OTHER BUILDING OR STRUCTURE ON THE SITE.

SIGNATURE OF OWNER: *[Signature]*  
 Director, Anchal Enclave Pvt. Ltd.

SIGNATURE OF STRUC. ENGINEER: *[Signature]*  
 Suresh Chatterjee

SIGNATURE OF GEO-TECHNICAL ENGINEER: *[Signature]*  
 Somnath Bhadra

DRAWN BY: IRNE ALI  
 SHEET NO. - 1/2  
 SIGN. OF L.B.S. (SCALE: 1:100)